

A large-scale construction site featuring a prominent blue tower crane in the foreground and several orange tower cranes in the background. The building under construction has a curved facade and is heavily scaffolded with orange and blue metal structures. The sky is clear and blue.

I FEEL
SLOVENIA

GREEN.
CREATIVE.
SMART.

INVESTMENT OPPORTUNITY:

**THERMAL VILLAGE OF
KOSTANJEVICA NA KRKI**

WHY SLOVENIA?

Foreign direct investment (FDI) is equally important to Slovenia's economic growth as it is for global GDP and jobs worldwide. The Slovenian government has been working on improving the environment to attract quality business to the country and, in turn, create new jobs. For Slovenia as an FDI location quality has always been its core value and its cutting edge. Attention to quality runs in the blood of its people and in combination with vocational and university education makes the country's workforce often **No. 1 reason to invest** in Slovenia.

Discover Slovenia's investment opportunities, visit

www.investslovenia.org.





FACTS ABOUT SLOVENIA

One of the fastest growing CEE countries

- GDP growth in 2018: 4.5 % (**4th highest** in EU-28)
- Estimated GDP growth for 2019: 3.4 %
- Long-term GDP growth: 2.2 %
- **25th most developed country** (Human Development Index 2018, UN)
- **15th place on Quality of Life Index** 2019 (Numbeo)
- **11th safest country** (Global Peace Index 2018)
- **2nd most secure energy system** in the world
- Well-developed ICT infrastructure
- Strong healthcare system

THERMAL VILLAGE OF KOSTANJEVICA NA KRKI

The vision of the construction of a new thermal village in Kostanjevica na Krki envisages an exclusive spa resort with public baths and individual houses with private thermal water pools. In nearly 5 hectares, there will be two distinctive but together connected areas - public and private.

In the smaller part of the new thermal village, there will be a public area with an administration building, a reception, a restaurant, and other public facilities that service and support public bath (including parking). The public site will also include a large, more than 5.000 m² big thermal water natural pool available to the general population.

The remaining area of the new thermal village will be more private and available to the owners and tenants of the individual houses. There will be 28 private plots of land (700-900 m² each) on which individual houses with private thermal natural pools will be built. Houses are one storey (P+M) tall and 8,60 m x 13,30 m (228 m²) big units with living, sleeping and leisure areas. In addition to the common living and sleeping areas, each house will have its gym, sauna, indoor jacuzzi and outdoor deck with a natural pool of warm thermal water. Each house will be able to accommodate up to 10 persons per night. Access to the private plots with big courtyards for parking will be provided from the

...

<https://investslovenia.spiritslovenia.eu/p/1497>



Promoter

Savaprojekt d.d.

Location:

The proximity of the main highway A2 Ljubljana-Obrežje with the border of the Republic of Croatia and closeness to the Cerklje ob Krki Airport provides tremendous opportunities for the Kostanjevica na Krki visitors or guests to explore other cities and other regions of Slovenia - the capital city of Slovenia, Ljubljana is more minor than an hour drive away. All of this makes Kostanjevica na Krki one of the top destinations in our country. (45.8579N 15.43584E)

Investment 39.00 MIO EUR

Type of investment

Land



Sector

Tourism

Size of land plot 50000 m²

Dedicated use of space Areas for tourism BT

Actual use of space The best farmland K1

The estimated value 39.00 EUR

The land plot is for sale

Utilities + Distance

electric current

water supply

optical network

telephone network

sewage

Owner information

Private landowners



Austria

Slovenia

Croatia

Bosnia and Herzegovina

Graz

Maribor

Celje

Zagreb

Karlovac

Rijeka

Pula

Szombathely

Győr

Székesfehérvár

Veszprém

Siófok

Kaposvár

Pécs

Osijek

Slavonski Brod

Tuzla

Zenica

E70

E59

E59

E71

E73

E65

E70

E71

E661

E70



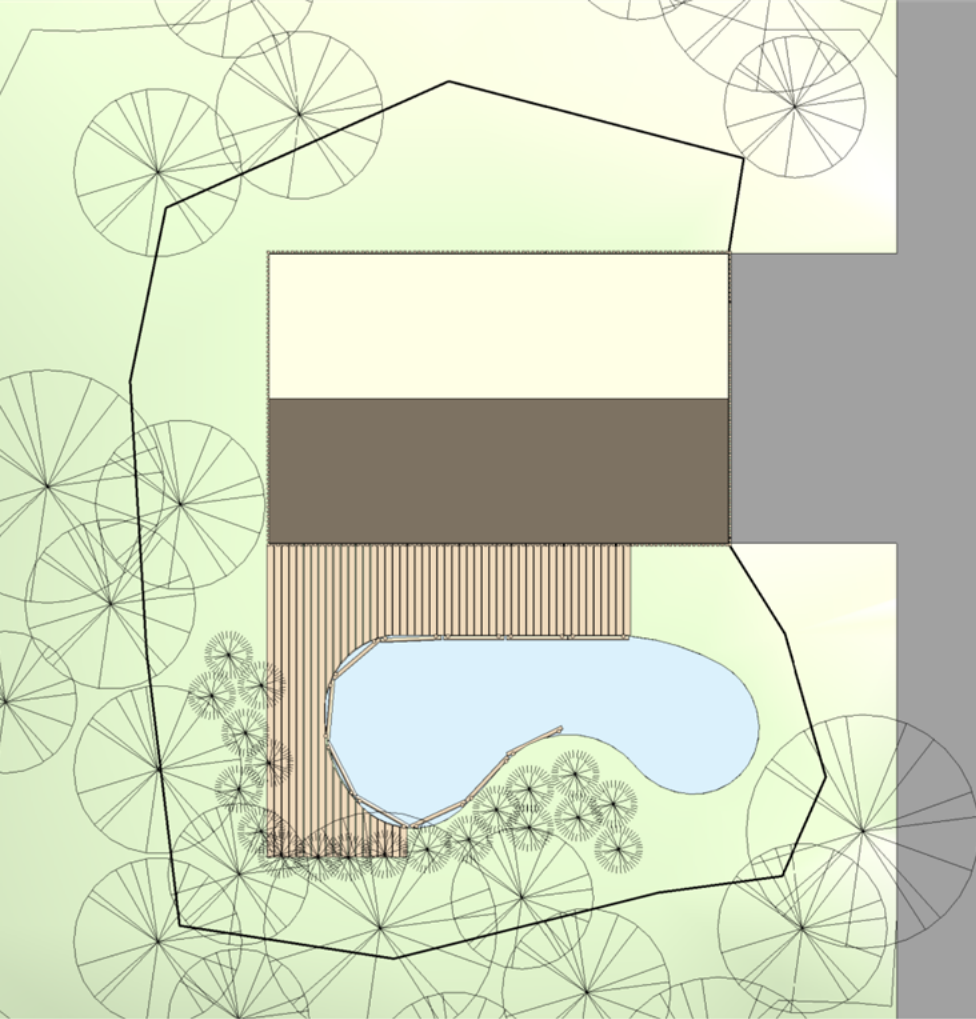

Contact information

Ladko Petretič



Občina Kostanjevica na Krki, Ljubljanska cesta 7, 8311 Kostanjevica na Krki

00386 7 49 87 275



ladko.petretic@kostanjevica.si



Business card

Autogenerated by: SPIRIT INVEST SLOVENIA

Slovenian Public Agency for Entrepreneurship,
Internationalization, Foreign Investments and Technology

T: +386 1 589 1 870, **E:** invest@spiritslovenia.si
www.investslovenia.org

Financed by: The Republic of Slovenia and the European Union
under European Regional Development Fund

SPIRIT Slovenia is not responsible for the content of the project descriptions and the views expressed are of the external contributors and not of SPIRIT Slovenia.



Slovenian Public Agency for
Entrepreneurship,
Internationalization, Foreign
Investments and Technology



SLOVENSKA
POSLOVNA
TOČKA



REPUBLIC OF SLOVENIA



EUROPEAN UNION
EUROPEAN REGIONAL
DEVELOPMENT FUND